

Tennessee Dome Home



This is the long-time (30 years) personal home of architect Ron Nelson (Ron Nelson and Assoc.) Ron has been designing custom homes and businesses for God Only Knows how many years. As he and his wife Barb are entering retirement, they are looking to move due to health considerations.



The Dome House on Hang Dog Ridge

First, don't ask us how this place got its name. We don't know. We only know that some of the real locals called it that when we moved in. "You the folks that are livin' up on Hang Dog Ridge?" "Yup!"



The name might not fit, but living here has been wonderful. In the fall the leaves turn color and drop from the trees. Slowly Bluff Mountain and the north face of the Chilhowee range come into view. Then, after more leaves drop, the main range of the Smoky's in the National Park start to show in the east.

We have been in the yard in our shirt sleeves watching it snow on Bluff Mountain. We have watched huge wet snowflakes pile up on every little branch and twig. We have seen fog condense and cover everything with an icy layer that sparkled like the inside of a diamond when the sun came up in the morning.

In the spring the redbud trees on the west slope are covered with blooms and dogwoods add their brilliant white. The leaves come on the trees and the road to the house becomes a green tunnel that makes the house seem more private. The more leaves that show the more the mountains disappear until we are wrapped in a wonderful green cocoon.

It is the changing of seasons. The opening and closing of vistas that has made each of the seasons so special here on Hang Dog ridge.

And, of course, there are the animals. The deer abound and flocks of wild turkeys roam through. There is the family of red fox who's den was in the east hollow and the mother skunk who decided to have her babies in our barn. The family of totally curious raccoons who love the crawfish in the west bottom. And all of the little ones.

Tennessee Dome Home

Why a Dome?



It didn't start out to be a dome. Architect's are funny. They like to do things differently and the easiest way to be different is to try it out on yourself. We designed a home that was different. Very different. So different that no one would finance it. Finally the last bank said "no" and we responded with the most stupid thing we could think of - "Would you finance a dome then?"

The answer was a surprising "yes". Ron designed it. We built the dome.

Have we ever been sorry? Not for an instant. It is a light and bright place to be, even when the outside is cloudy and dark. It is open. The ceilings soar. Spirits soar with them. It is hard to be gloomy in this house.

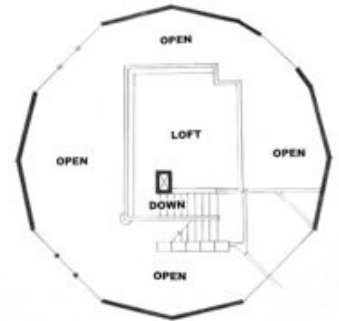

And it has changed over the years. Improved, we think. Ron loves to cook so the kitchen has all of the best appliances. There is the water purification system. There are the built in chests in the dressing area. The desk in the study area. The double face bookshelves that line the stairs. The so very convenient laundry closet, and much much more.



Now there is the new guest house and studio that used to be the horse stable. Use it for an office, or an in-law apartment, or just guests as it was intended. It is our final addition to the place and one we are proud of.

We know this house is not for everyone. It takes special people to live in this open and free specialness. We hope you will have as much fun living here as we have.

Ron and Barb Nelson



**Domes are
Light and
Strong!**

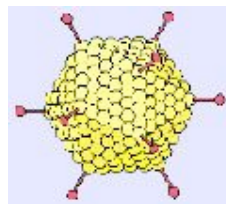

Tennessee Dome Home

Features

Two DirecTV outlets

Wired for Direcway satellite internet service.

Wired for emergency generator - 5KW Generac Portable Generator is included.

Wood parquet floors in entry and main level are "Gammapar" vinyl impregnated oak. They require only the care of a vinyl floor.

Entry has original laminated/fused/sand blasted glass panel designed by May Studios titled "San Andreas"

Water system is a private well with submersible pump less than 10 years old.

- pressure tank
- whole house particle filter
- water softener
- ultra violet water purifier
- 50 gal. gas water heater
- (Studio/guest house has separate 30 gal. electric water heater)

Sewage system is a private septic tank and drain field.

House has electric air conditioning and gas heat. Unit new in 1993. Studio/guest house has an electric heat pump for heating and air conditioning.

Kitchen includes:

- 42" wide Kitchenaid built-in refrigerator/freezer
- Kitchenaid disposal
- Whirlpool dishwasher
- Crispwave microwave with broiler unit
- Kitchenaid white glass gas cooktop
- GE electric self-cleaning oven
- 900 cfm remote exhaust fan
- All mica cabinets have adjustable mica shelves
- All drawers have full extension side guides

Built-in chests in dressing area have full extension side guides and mica drawer bottoms

Built in bed platforms in both sleeping areas.

Two way book shelves line the stair to the loft where there are additional book shelves.

Built-in desk with separate computer table and file cabinets.

Vermont Castings classic "Defiant" cast iron wood stove with gas log and remote starter

Large fenced dog yard with two way dog door in entry

Whole house surge protection.

Dome ceiling is three coat plaster over expanded wire mesh.

Roofs of storage building and studio/guest house are lifetime EPDM roofing.

School district is Seymour (Sevier County Schools or Great Schools)

2005 taxes were \$503

Asking price on 18.6 wooded acres is \$350,00

Tennessee *Dome Home*

Details

Location

The Tennessee Dome House is located about 1 mile from US 441 almost half way between Seymour and Sevierville, TN. It is a short drive to Knoxville, Sevierville, Pigeon Forge (Dollywood amusement park), and Gatlinburg. The Great Smoky Mountains National Park is another short drive. While the location is in the middle of everything, it is in a quiet wooded area not affected by seasonal traffic.

The Property

The main tract, which includes the house and guest house, is a ridge top with 11.7 acres. The second tract is a hilltop with 5.98 acres. The third tract is another hilltop with .92 acres. The total acreage is 18.6. The entire property is wooded. The previously recorded hilltop tracts can be marketed if an owner desires.

The Geodesic Dome House

Architecturally designed, it is a 40 foot diameter dome laced with 13 skylights. This is a classic dome design with the entire dome surface left intact. There is a separate building inside the dome which contains a bath, the kitchen, closets and stairs on the main floor with a loft over. Spaces for sleeping, dressing, dining, living, and study are around this central little "building". A lower level contains another sleeping area, bath, and utilities. There are two decks on the main level and a lower level deck in the woods. Square footage is about 1800. Please see floor plans.

Guest House/Studio

This separate building is 650 square feet and includes a sleeping area with closet, a bath, and a large studio or living room with a unit kitchen. There is a 12' x 14' deck jutting out into the woods that overlooks the deer trail below. The large north facing window are for the artist.

Storage Building

The 10' x 10' storage building is fully insulated and has electrical service.

The geodesic dome house was built in 1976 and has gone through almost continuous updates since then. All appliances, including the heating system are from 1993 or later. The studio/guest house was built as a stable in 1980. The conversion from a stable is new in 2006.

Tennessee Dome Home

Contact

Ron & Barb Nelson
1547 Longbranch Rd.
Seymour, TN 37865
Phone: (865) 453-2442
Email: tndomehome@aol.com

Asking Price: \$350,000

